

Great Hall



Reminiscent of a north woods lodge, the Great Hall has a soaring two-story beamed ceiling and a beautiful stone fireplace. The rental of the Great Hall also includes the use of the Cupola, the Hearth Room with an additional fireplace, and the outdoor Veranda. These rooms are only available after 5:30 pm. Spaces accommodate 225-250 people, depending upon the arrangement.

Capacities:

250 standing reception

225 dinner seating

See Reverse Side for Floor Plans



**SCHLITZ
Audubon
NATURE
CENTER**

Great Hall

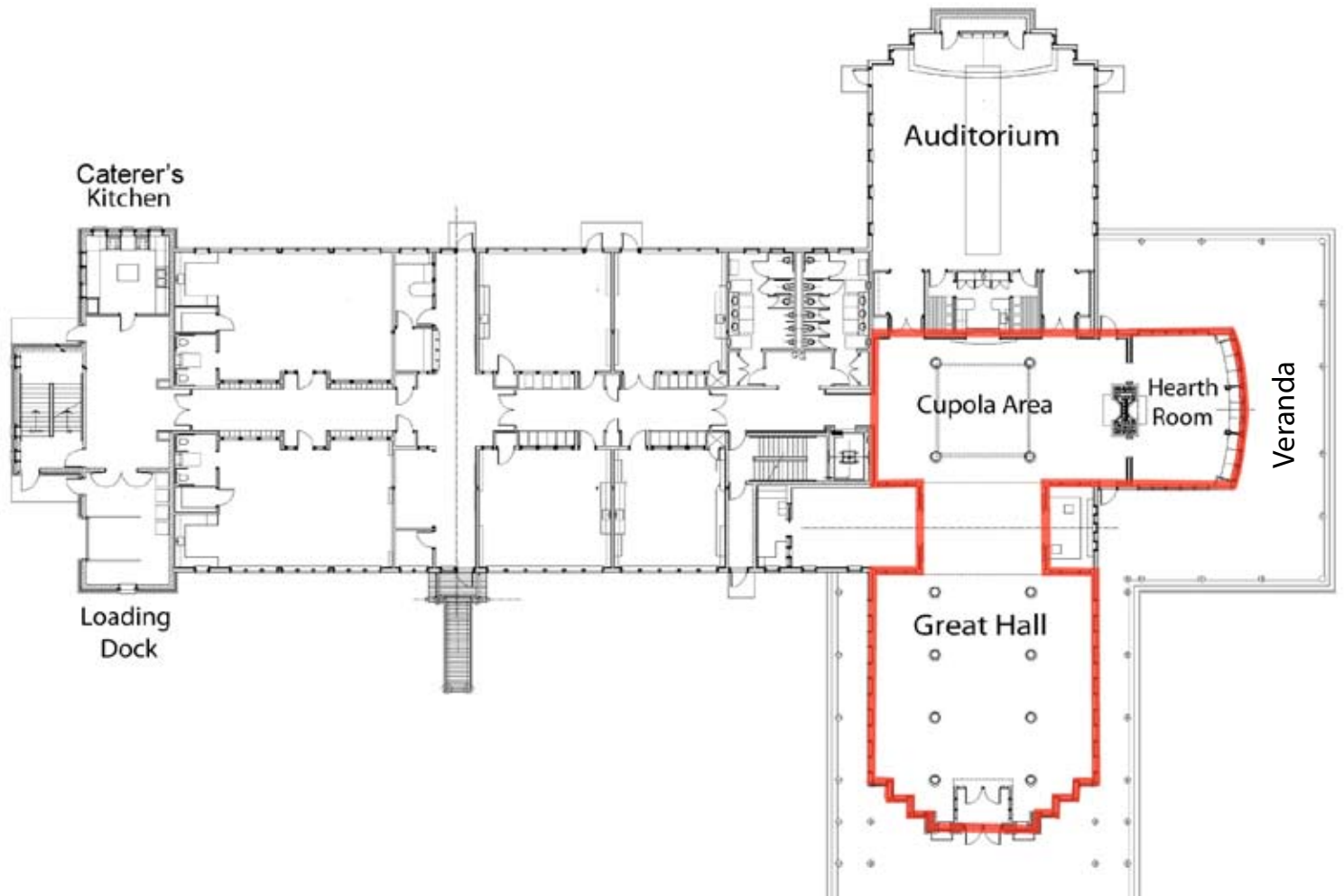

Great Hall rental space outlined in red